



DEPARTMENT OF THE NAVY
NAVAL STATION NORFOLK
1530 GILBERT STREET SUITE 2000
NORFOLK, VA 23511-2722

5090
Ser N4/

From: Commander, Naval Station Norfolk
To: Parents and Staff

Subject: Naval Station Norfolk Youth Center, Building U40 Drinking Water

Encl: (1) Overview of Results
(2) Complete Test Results
(3) Floor Plan of the YC

The Navy is committed to maintaining safe drinking water on its installations. Our drinking water distribution system is regularly tested for lead and is in compliance with the Environmental Protection Agency's (EPA) Lead and Copper Rule and the Safe Drinking Water Act.

Lead exposure is a particular concern for children. Lead in drinking water typically comes from the plumbing inside buildings including lead service lines, fittings, solder, water fountains/coolers, or water faucets. Navy policy requires we test the lead content of drinking water in priority areas such as youth centers (YCs), child development group homes (CDGHs), and child development centers (CDCs). Testing at the Naval Station Norfolk Youth Center (YC), Building U40 was conducted on June 17, 2022.

I am pleased to report that all drinking water intended for consumption, to include drinking water and water intended for cooking or washing, is at or below the Navy lead screening level of 15 parts per billion (ppb).

Navy environmental personnel conducted this testing at the Naval Station Norfolk YC Building U40 following Navy policy. Samples from various locations in the YC were sent to a state-accredited laboratory for analysis.

We also tested other sinks used for washing. These fixtures were also below screening levels for lead in schools and day care centers. In all, 16 samples were taken and tested.

A copy of all test results is enclosed for information. You can also see a hard copy of our water testing results at the Naval Station Norfolk YC, Building U40, which is open Monday to Friday (0600 to 1800).

- a. To learn more about lead in drinking water visit the following EPA website:
<https://www.epa.gov/ground-water-and-drinking-water/basic-information-about-lead-drinking-water>
- b. To learn more about the installations public water supplier, see their annual water quality report:

<https://cnrma.cnmc.navy.mil/Operations-and-Management/Environmental-Support/Drinking-Water-Quality-Information/>

While lead in the drinking water at these facilities is below the Navy screening levels for schools and daycare centers, if you have any health related questions or concerns about lead exposure, you are encouraged to contact your health care provider or, if you are a TRICARE beneficiary, use the Mid-Atlantic Appointment Center to schedule an appointment with your primary care provider at 1-866-645-4584.

Sincerely,

A handwritten signature in black ink, appearing to read 'D. Dees', with a stylized flourish at the end.

David Dees
Captain, United States Navy
Commanding Officer

Overview of Testing Results for Lead in Drinking Water and Corrective Actions for Naval Station Norfolk YC (Building U40)

The Navy is committed to maintaining safe drinking water on its installations. City of Norfolk water supplied to the Navy and the Navy's water distribution system is regularly tested and in compliance with the Safe Drinking Water Act. Because lead exposure is a particular concern for children, and lead may be added to drinking water due to its presence in pipes, fittings, solder, and fixtures inside a building, the Navy policy requires that we test the lead content of drinking water in priority areas such as youth centers (YCs), child development group homes (CDGHs), and child development centers (CDCs) every five years.

Navy environmental personnel conducted lead testing at the Naval Station Norfolk YC Building U40 in accordance with Navy and EPA guidelines. Samples from various locations in the YC were sent to a state-certified laboratory for analysis.

At the Naval Station Norfolk YC Building U40, outlets used for drinking, cooking, and washing were tested. Out of 16 samples collected, no water outlet tested above the Navy screening level of 15 parts per billion (ppb) for lead in drinking water in schools and YCs.

A copy of all test results is enclosed for your information. The test results are presented in two tables:

- Table 1 **Summary of Results** summarizes the data by category of use (e.g., drinking, cooking, washing).
- Table 2 **Summary Statistics** summarizes all the data.

A floor plan of the Naval Station Norfolk YC Building U40 has also been included to show the locations of the fixtures that tested below 15 ppb.

Table 1 provides a description of each sampling location using three columns; *Category*, *Sampling ID*, and *Outlet Description*. The *Category* column gives information about whether the outlet is used for drinking water (water fountain), cooking (food preparation), or washing (primarily hand-washing or brushing teeth). The *Sample ID* column is the identification used to label each sample bottle. The *Outlet Description* column contains additional information to describe the outlet sampled under each category.

The next set of columns in **Table 1** provide *Initial Sampling Results*, and for those locations that exceeded the recommended screening level of 15 ppb the *Re-sampling Results*.

EPA sampling protocol requires water to not be used for between 8 and 18 hours prior to first draw sampling. Therefore, *Initial Sampling Results* were from first draw samples collected early in the morning before the YC opened and before any water was used. The *Initial Sampling Results* also indicate whether resampling is required and the date that fixtures greater than 15 ppb were secured. Outlets that exceeded 15 ppb are highlighted in yellow.

The *Re-sampling Results* includes columns for *First Draw* and flushing samples which help determine the source of lead. For cooking and washing outlets, aerators are removed and cleaned before retesting:

- If the lead concentration of the 30 second flush sample resulted in lower than 15 ppb lead, the aerators were the source of lead and the outlet can be used for drinking if the aerators are cleaned on a regular basis. None of the outlets tested fit in this category.
- If the lead concentration of the resampled first draw (but not the follow up 30 second flush) was greater than 15 ppb, the fixture was the source of lead. These fixtures can be used if water is flushed for 30 seconds before first use of the day or if the fixtures are replaced and retesting confirms that the new fixtures do not leach lead. None of the outlets tested fit in this category.
- If the lead concentration of the sample following the 30 second flush was greater than 15 ppb and greater than the lead concentration of the first draw resample, the source of lead is the plumbing upstream of the outlet. These outlets should be disconnected/removed from service unless upstream plumbing is replaced. None of the outlets tested fit in this category.

The *Corrective Actions* column describes actions that were taken to remediate the source of lead. In the event that fixtures or upstream piping are replaced, there are columns for sampling data that confirms that the corrective actions were successful in reducing lead below 15 ppb.

To learn more about lead in drinking water visit the following EPA website:

<https://www.epa.gov/ground-water-and-drinking-water/basic-information-about-lead-drinking-water>

To learn more about the installation's public water supplier, see their annual water quality report:

https://www.cnic.navy.mil/regions/cnrma/om/environmental_support/water_quality_information.html

To answer any questions you may have on the sampling program contact, please contact Norfolk Station Norfolk Public Affairs Officer at 757-431-3155. If you have any health questions or concerns, you are encouraged to contact your health care provider or, if you are a TRICARE beneficiary, use the Mid-Atlantic Appointment Center to schedule an appointment with your primary care provider at 1-866-645-4584.

Enclosures:

1. Complete Test Results
2. Floor Plan of the Naval Station Norfolk YC Building U40

Priority Areas Lead Testing and Corrective Actions (June 2022)
Naval Station Norfolk, Youth Center, Building U40

Table 1. Summary of Results

SAMPLING LOCATION DESCRIPTION				INITIAL SAMPLING RESULTS		RE-SAMPLING RESULTS				CORRECTIVE ACTIONS	POST REMEDIATION SAMPLING RESULTS		
				Lead Screening Level of 15 ppb							Recommended Level = 15 ppb		
CATEGORY	SAMPLE ID NO.	SAMPLE ID	Outlet Description	Comments	First Draw (ppb)	Retest required?	Date Fixture Secured?	Water Fountain 15 min. Follow up Flush Sample - Collected day before First Draw Sampling (ppb)	First Draw (ppb)	Follow up Flush - Collected 30 seconds after First Draw Sampling (ppb)	Description	First Draw (ppb)	Follow up Flush - Collected 30 seconds after First Draw Sampling (ppb)
SAMPLING DATE					6/17/2022			mm/dd/yyyy	mm/dd/yyyy	mm/dd/yyyy		mm/dd/yyyy	
RESULTS DATE					6/27/2022			mm/dd/yyyy	mm/dd/yyyy	mm/dd/yyyy		mm/dd/yyyy	
DRINKING	5	NS-U40-K-WFC-FD	Kitchen water fountain (cooler)		non-detect	No	N/A	N/A	N/A	N/A	N/A	N/A	N/A
DRINKING	8	NS-U40-GYM-WFC-FD	Gym water fountain (cooler)		non-detect	No	N/A	N/A	N/A	N/A	N/A	N/A	N/A
DRINKING	9	NS-U40-EATING-WFC-FD	Eating Area water fountain (cooler)		non-detect	No	N/A	N/A	N/A	N/A	N/A	N/A	N/A
COOKING	4	NS-U40-K-K-FD	Main kitchen sink		non-detect	No	N/A	N/A	N/A	N/A	N/A	N/A	N/A
COOKING	6	NS-U40-LOUNGE-K-FD	Staff lounge kitchen sink for dishwashing, food prep		non-detect	No	N/A	N/A	N/A	N/A	N/A	N/A	N/A
WASHING	1	NS-U40-BATHG-HHWA-FD	Girls' Restroom high hand washing faucet		non-detect	No	N/A	N/A	N/A	N/A	N/A	N/A	N/A
WASHING	2	NS-U40-BATHG-HHWB-FD	Girls' Restroom high hand washing faucet		non-detect	No	N/A	N/A	N/A	N/A	N/A	N/A	N/A
WASHING	3	NS-U40-BATHB-HHW-FD	Boys' Restroom high hand washing faucet		non-detect	No	N/A	N/A	N/A	N/A	N/A	N/A	N/A
WASHING	7	NS-U40-BATHA-HHW-FD	Restroom A high hand washing faucet		non-detect	No	N/A	N/A	N/A	N/A	N/A	N/A	N/A
WASHING	10	NS-U40-EATING-HHW-FD	Eating Area high hand washing faucet		non-detect	No	N/A	N/A	N/A	N/A	N/A	N/A	N/A
WASHING	15	NS-U40-BATHWA-HHWA-FD	Women's Restroom A high hand washing faucet		non-detect	No	N/A	N/A	N/A	N/A	N/A	N/A	N/A
WASHING	16	NS-U40-BATHWA-HHWB-FD	Women's Restroom A high hand washing faucet		non-detect	No	N/A	N/A	N/A	N/A	N/A	N/A	N/A
WASHING	17	NS-U40-BATHMA-HHWA-FD	Men's Restroom A high hand washing faucet		non-detect	No	N/A	N/A	N/A	N/A	N/A	N/A	N/A
WASHING	18	NS-U40-BATHMA-HHWB-FD	Men's Restroom A high hand washing faucet		non-detect	No	N/A	N/A	N/A	N/A	N/A	N/A	N/A
WASHING	19	NS-U40-BATHWB-HHW-FD	Women's Restroom B high hand washing faucet		9	No	N/A	N/A	N/A	N/A	N/A	N/A	N/A
WASHING	20	NS-U40-BATHMB-HHW-FD	Men's Restroom B high hand washing faucet		10	No	N/A	N/A	N/A	N/A	N/A	N/A	N/A

Table 2. Summary Statistics

CATEGORY	INITIAL SAMPLING RESULTS		RE-SAMPLING RESULTS			POST
	Lead Screening Level of 15 ppb					First Draw
	First Draw	Water Fountain Follow up Flush Sample - Collected day before First Draw Sampling	First Draw (ppb)	Follow up Flush - Collected 30 seconds after First Draw Sampling	First Draw	
Total Drinking	3	N/A	N/A	N/A	N/A	N/A
Total Drinking > 15 ppb	0	N/A	N/A	N/A	N/A	N/A
Total Cooking	2	N/A	N/A	N/A	N/A	N/A
Total Cooking > 15 ppb	0	N/A	N/A	N/A	N/A	N/A
Total Washing	11	N/A	N/A	N/A	N/A	N/A
Total Washing > 15 ppb	0	N/A	N/A	N/A	N/A	N/A
Total Samples	16	N/A	N/A	N/A	N/A	N/A
Total Samples > 15 ppb	0	N/A	N/A	N/A	N/A	N/A

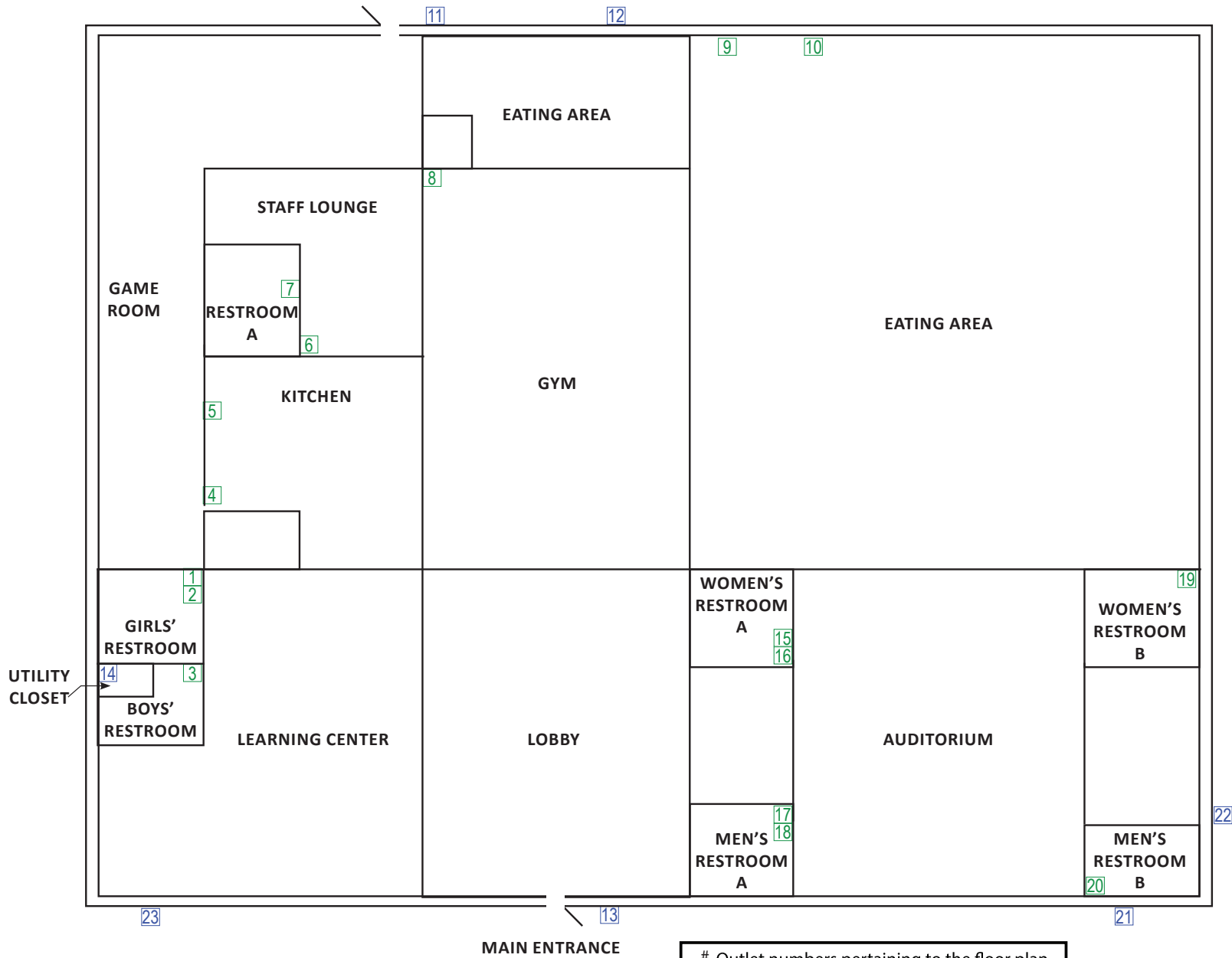

1 **BUILDING U40 - First Floor Plan**

NOT TO SCALE

Outlet numbers pertaining to the floor plan.
 Green = Below 15 ppb
 Blue = Not Sampled



Note: No outlets are located on the basement and second floor so the basement and second floor plans are not shown

SAMPLING RESULTS FOR TESTING LEAD IN DRINKING WATER AT THE NAVAL STATION NORFOLK YOUTH CENTER, BUILDING U40

	Type of Fixture	Location Description	Exceeded?
1	High handwashing faucet	Girls' Restroom	No
2	High handwashing faucet	Girls' Restroom	No
3	High handwashing faucet	Boys' Restroom	No
4	Kitchen sink for dishwashing and food preparation	Kitchen	No
5	Water fountain (cooler)	Kitchen	No
6	Kitchen sink for dishwashing and food preparation	Staff Lounge	No
7	High handwashing faucet	Restroom A	No
8	Water fountain (cooler)	Gym	No
9	Water fountain (cooler)	Eating Area	No
10	High handwashing faucet	Eating Area	No
11	Hose bib	Outside on the south side of Building U40	Not sampled
12	Hose bib	Outside on the south side of Building U40	Not sampled
13	Hose bib	Outside on the north side of Building U40	Not sampled
14	Utility Sink	Utility Room	Not sampled
15	High handwashing faucet	Women's Restroom A	No
16	High handwashing faucet	Women's Restroom A	No
17	High handwashing faucet	Men's Restroom A	No
18	High handwashing faucet	Men's Restroom A	No
19	High handwashing faucet	Women's Restroom B	No
20	High handwashing faucet	Men's Restroom B	No
21	Hose bib	Outside on the northwest side of Building U40	Not sampled
22	Hose bib	Outside on the west side of Building U40	Not sampled
23	Hose bib	Outside on the northeast side of Building U40	Not sampled

Outlet numbers pertaining to the floor plan
 Green = Below 15 ppb
 Blue = Not sampled